

OSLO

F U R N I T U R E

# OSLO

FURNITURE

---

- Solid Wood Furniture
- Made in Canada
- Distinctive Style
- Customizable
- Made-to-Order
- Short Lead Times
- Since 1988



Simple, clean lines, light and pale color palette, minimalist, nature-inspired design, democratic, highly functional and with a high quality—these are all key attributes of what has been known since the mid-20th century as “Scandinavian design”.



Scandinavian design has captured the hearts and eyes of décor lovers around the globe for many decades. European Nordic countries have always had a strong sense of style and appreciation for home decor and aesthetics.

Nordic designers' love for clean lines, organic textures, and minimal shapes have made waves on the mid-century design scene. The influence has been so great that many Scandinavian Mid-Century designs are still very present in homes today. In fact, Scandinavian designs are some of the most coveted and easily recognized furniture designs around the world.

We at OSLO Furniture have the same passion for Mid-Century Modern furniture that inspired the likes of Arne Jacobsen creator of the Egg and Swan chairs or Charles and Ray Eames creators of The Shell Chair.

We hope that OSLO Furniture will inspire you as well and that you will find a piece to add to your home to enjoy for many years to come.



Luke Martin  
OSLO Furniture  
519.664.3073

# DALVIK DINING SET

Inspired by Scandinavian

## TABLE SPECS

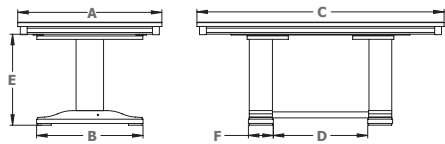

## Dimensions

A	B	C	D	E	F
36"	31"	60"	25"	28¼"	4½"
42"	31"	72"	35"		
48"	31"	84"	47"		
		96"	55"		
		108"	63"		
		120"	75"		

## Solid Top Configuration

Widths	36", 42", 48"
Lengths	60", 72", 84", 96", 108", 120"
Top Thickness	1¾"
End Extension Option	Yes
End Extension Type	Plug in



## MONAS CHAIR

Total Height	36"
Seat Height	18½"
Width	18"
Total Depth	22¾"
Seat Depth	17½"



## DALVIK SERVER

Depth	18"
Width	42" thru 96"
Height	36"



# KUSTAVI DINING SET

Inspired by Scandinavian

## TABLE SPECS

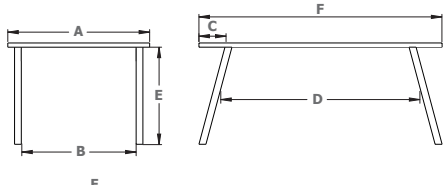

## Dimensions

A	B	C	D	E	F
42"	34"	9 3/8"	60 5/32"	28 3/4"	72"

## Solid Top Configuration

Widths	36," 42," 48"
Lengths	60," 72," 84," 96," 108", 120"
Top Thickness	1 1/4"
End Extension Option	Yes
End Extension Type	Plug in

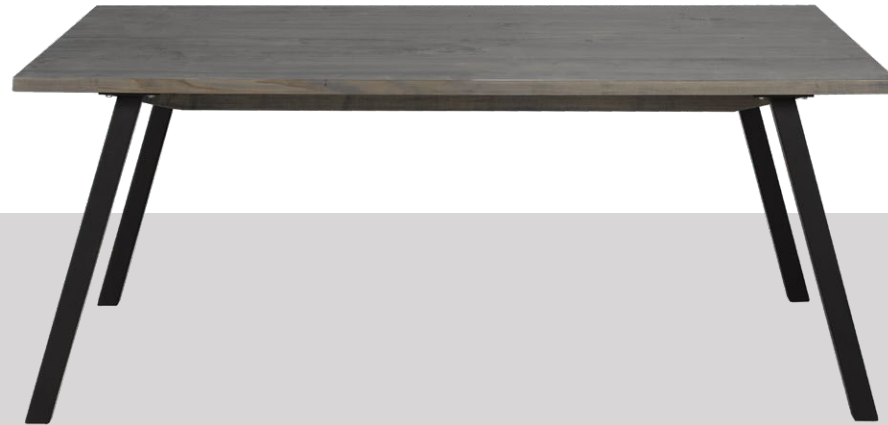

## MYRA CHAIR

Total Height	31"
Seat Height	19 1/2"
Width	19 1/2"
Total Depth	21 1/2"
Seat Depth	17"



## KUSTAVI BENCH

Depth	14"
Width	42" thru 96"
Height	18"



## NORDMARK SIDEBOARD

Depth	18"
Width	60," 72"
Height	32"
Shelves	Adjustable





# LEKSVIK DINING SET

Inspired by Scandinavian

## TABLE SPECS

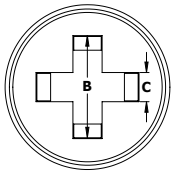
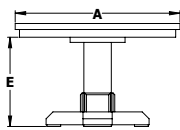

## Dimensions

A	B	C	E
42"	38"	1½"	29"
48"	40"		
52"	40"		
54"	40"		
60"	42"		

## Solid Top Configuration

Diameters	42," 48," 52," 54," 60"
Top Thickness	1"



## SVENE CHAIR

Total Height	33¾"
Seat Height	19"
Width	20"
Total Depth	22"
Seat Depth	17½"



# NORSEMAN DINING SET

Inspired by Scandinavian

## TABLE SPECS

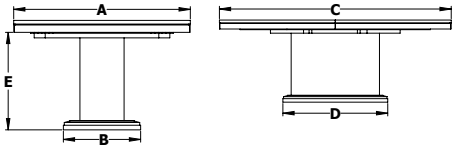

## Dimensions

A	B	C	D	E
36"	25"	72"	47½"	28¾"
42"	25"	84"	47½"	
48"	25"	96"	47½"	
		108"	47½"	
		120"	47½"	

## Solid Top Configuration

Widths	36," 42," 48"
Lengths	72," 84," 96," 108," 120"
Top Thickness	1¼"
End Extension Option	Yes
End Extension Type	Plug in



## FJORD CHAIR

Total Height	33½"
Seat Height	17¾"
Width	18"
Total Depth	22¾"
Seat Depth	17"



# SIMO DINING SET

Inspired by Scandinavian

## TABLE SPECS

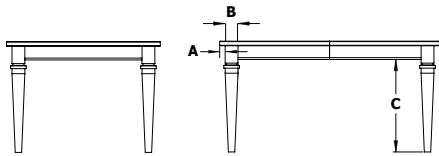

### Dimensions

A	B	C	D	E
21 <sup>1</sup> / <sub>8</sub> "	2 <sup>3</sup> / <sub>4</sub> "	26"		

### Centre Extension Configuration

Widths	36," 42," 48"
Lengths	36," 42," 48," 60," 72," 84"
Top Thickness	1"
Leaf Opening	36"
Leaf Opening	12," 16," 18"
Leaf Storage	Yes

### Solid Top Configuration

Widths	36," 42," 48"
Lengths	36," 42," 48," 60," 72," 84," 96," 108," 120"
Top Thickness	1"
End Extension Option	No

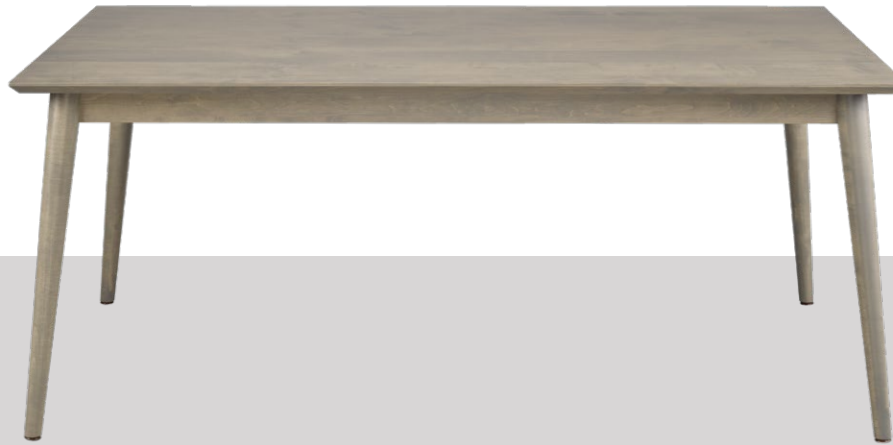

### ESKOLA CHAIR

Total Height	34"
Seat Height	18 <sup>1</sup> / <sub>2</sub> "
Width	20"
Total Depth	25"
Seat Depth	18 <sup>1</sup> / <sub>2</sub> "



### SIMO BENCH

Width	14"
Length	42" thru 96"
Height	18"



### SKALO SIDEBOARD

Depth	18"
Width	60," 72"
Height	36"
Shelves	Adjustable



# SKAGEN DINING SET

Inspired by Scandinavian

## TABLE SPECS

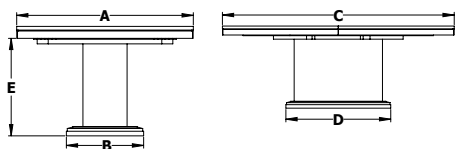

### Dimensions

	A	B	C	D	E
	42"	30"	66"	50"	26 <sup>3</sup> / <sub>4</sub> "
	48"	30"	72"	56"	26 <sup>3</sup> / <sub>4</sub> "
		30"	84"	60"	26 <sup>3</sup> / <sub>4</sub> "
		30"	96"	64"	26 <sup>3</sup> / <sub>4</sub> "

### Centre Extension Configuration

Widths	42", 48"
Lengths	66", 72", 84"
Top Thickness	1"
Leaf Opening	48"
Leaf Widths	12", 16", 18"
Leaf Storage	Yes - <i>with no skirts</i>

### Solid Top Configuration

Widths	42", 48"
Lengths	72", 84", 96"
Top Thickness	1"
End Extension Option	No



### WIND CHAIR

Total Height	30 <sup>3</sup> / <sub>4</sub> "
Seat Height	18 <sup>1</sup> / <sub>4</sub> "
Width	18"
Total Depth	20"
Seat Depth	16 <sup>1</sup> / <sub>2</sub> "





# SKIEN DINING SET

Inspired by Scandinavian

## TABLE SPECS

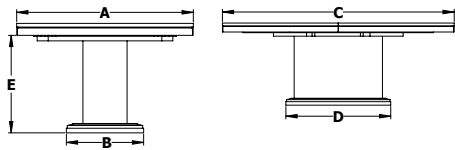

### Dimensions

A	B	C	D	E
36"	16"	72"	38"	28¼"
42"	17"	84"	44"	
48"	21"	96"	56"	
		108"	60"	
		120"	66"	

### Solid Top Configuration

Widths	36," 42," 48"
Lengths	60," 72," 84," 96," 108," 120"
Top Thickness	1¾"
End Extension Option	Yes
End Extension Type	Plug in



### PORI CHAIR

Total Height	35½"
Seat Height	19"
Width	18"
Total Depth	22½"
Seat Depth	16"

### BALTIC SIDEBOARD

Depth	18"
Width	60," 72"
Height	34"
Shelves	Adjustable

THIS CHAIR IS AVAILABLE ONLY  
IN 5 FABRIC CHOICES & BLACK LEGS



# STATLAND DINING SET

Inspired by Scandinavian

## TABLE SPECS

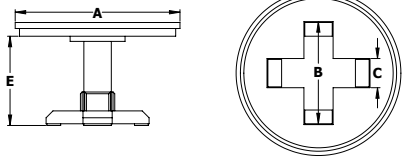

## Dimensions

A	B	E
48"	20"	28 $\frac{1}{4}$ "
52"	24"	
54"	24"	
60"	24"	

## Solid Top Configuration

Diameters	48," 52," 54," 60"
Top Thickness	1 $\frac{3}{4}$ "



## KOLDING CHAIR

Total Height	36 $\frac{1}{4}$ "
Seat Height	19"
Width	21 $\frac{1}{2}$ "
Total Depth	25"
Seat Depth	18"



# VIKING DINING SET

Inspired by Scandinavian

## TABLE SPECS

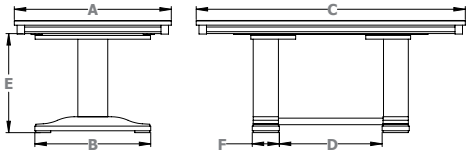

### Dimensions

	A	B	C	D	E	F
	42"	22"	60"	29"	28¾"	3½"
	48"	22"	72"	39"		
			84"	49"		
			96"	57"		
			108"	69"		
			120"	77"		

### Solid Top Configuration

Widths	42," 48"
Lengths	60," 72," 84," 96," 108," 120"
Top Thickness	1¼"
End Extension Option	No

THIS TABLE HAS A LIVE EDGE



## TALLBERG CHAIR

Total Height	36"
Seat Height	18½"
Width	18"
Total Depth	22¾"
Seat Depth	17½"

## LAXA SIDEBOARD

Depth	18"
Width	60", 72"
Height	36"
Shelves	Adj



# TOP TEXTURES

Hand  
Planed



Hand  
Scraped



Random  
Planed

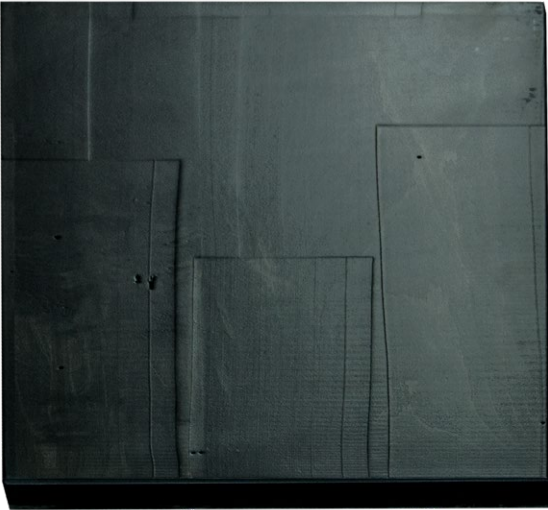

Ruff  
Cut





# SOLID WOOD CARE & MAINTENANCE

---

With a little care and maintenance, solid wood furniture can retain its original beauty and durability for a lifetime. However, for this to be possible, we have outlined some of the measures that need to be taken.

Solid wood is a living product. Our furniture is crafted from solid wood that is kiln dried, retaining enough moisture in the wood for the furniture to properly acclimatize to your home. Wood will however, continue to exchange moisture with the air, expanding and contracting in response to changes in relative humidity.

Solid wood's response to dry air is to lose moisture and shrink a bit. The halves of an extension table may part slightly, or a few tiny openings may appear on a surface. This will correct itself as the relative humidity rises, and the wood absorbs enough moisture to expand again. In extreme conditions the wood may be under enough stress to crack.

Solid wood's response to high humidity levels is to absorb moisture. This can result in making moving parts non-functional or may force apart mitred corners. This should correct itself when your relative humidity returns back to a normal percentage.

Below are a few tips to maintain your solid wood furniture

- Maintain your environment at a rate of 40% - 50% relative humidity to prevent swelling, shrinking, warping and cracking
- Keep your furniture away from direct sunlight or heat sources such as forced air, fire places, and radiators
- Clean your furniture with water only, as solvents can damage the finish
- Do not place hot objects directly onto the surface of a table

# CONFIGURATIONS

## Centre Extension Configuration

Centre extension configuration means extra leaves are added to the middle of the table top. Your table can be lengthened and shortened to suit the occasion.

- Pros**
  - Easy to extend and retract
  - Lengthen or shorten your table easily as necessary to accommodate your guests
  - Extra leaves can be stored inside the table top—See Leaf Storage Constraints for details
- Cons**
  - Leaf storage inside table may not accommodate all leaves—some leaves may need to be stored elsewhere



## Solid Top Configuration

Solid top configuration means the size of your table top always stays the same.

- Pros**
  - Aesthetically pleasing, no table leaf joints—stunning impression left by large, smooth table top area
  - No need to store extra leaves
- Cons**
  - Table cannot be lengthened or shortened to accommodate various group sizes



## Solid Top Configuration with End Extension Option

Solid top configuration with end extension option means your fixed length table can be lengthened if the need arises.

- Pros**
  - Adds length to a fixed length table when needed
- Cons**
  - End extensions cannot be stored in table—leaves need to be stored in closet area when not in use
  - End extensions can be unwieldy to handle and store



# FEATURES

## Leaf Storage Constraints



Depending on the configuration of your table, it may accommodate up to 2 leaves stored beneath the top. This handy feature means you don't need to worry about storing your leaves in a closet where they could accumulate scratches or dings.

**Below are listed the terms of storage.**

- No storage on single pedestal tables
- No storage on tables that are totally round or square when closed
- 36" width tables store 12" of extensions
- 42" width tables store 24" of extensions
- 42" wide stationary base tables with lengths longer than 84" plus two 12" extensions only store 12" of extensions
- 48" width tables store 24" of extensions

## Table Top Grain Direction

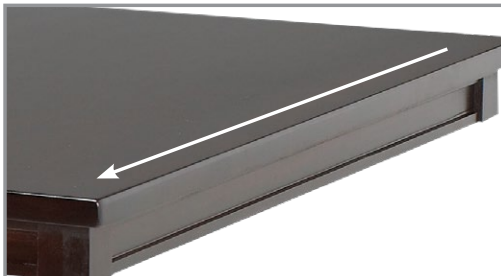

### Centre Extension Configuration

Grain pattern travels from side to side, the width of the table



### Solid Top Configuration

Grain pattern travels from end to end, the length of the table

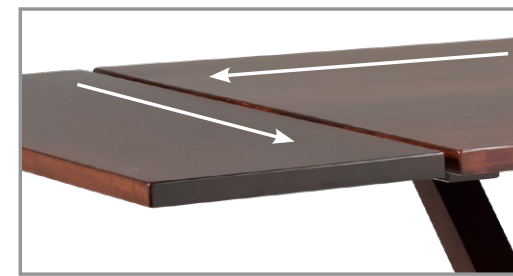

### Solid Top With End Extension Option

On the main table section grain pattern travels from end to end, the length of the table

On the end extensions grain travels from side to side, the width of the table







OSLO  
FURNITURE